

# 17mm Metal Shaft Rotary Potentiometer - With Switch

## MS17RS



### Part Number

MS17RS - **B** **10K**, L - **20** **KC**

↓ Taper      ↓ Resistance Value      ↓ Shaft Type  
 ↓ With Switch      ↓ Shaft Length

### Dimensions

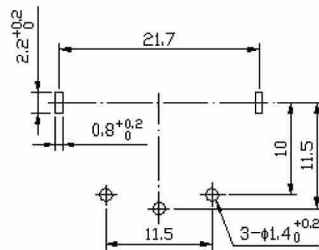
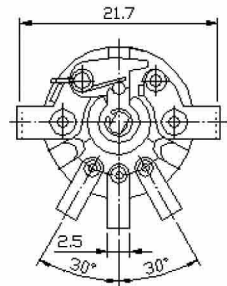
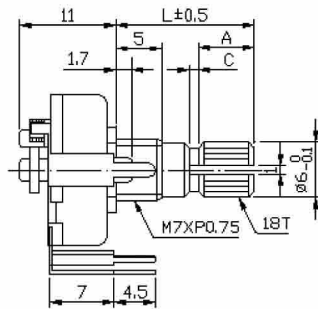

### CIRCUIT

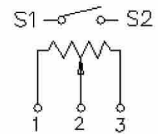

### Shaft Type

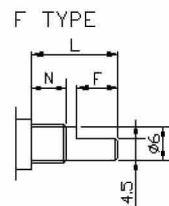
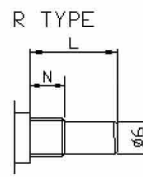
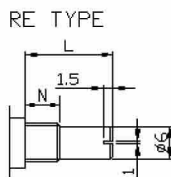
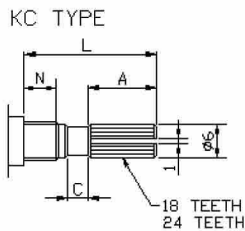

N:5m/m

SHAFT-TYPE	L	10	15	20	25	30	35	40
KC	A	3,2	6	10	12	12	12	12
	C	0,5	1	2	2	4	4	4
F	F	4	7	12	12	12	12	12
R,RE	L	10	15	20	25	30	35	40