

- Single-Turn / Cermet / Industrial / Sealed
- Top and side adjust types (F,P,H,W,X most popular)

CE10ST-WT Series Trimming Potentiometer

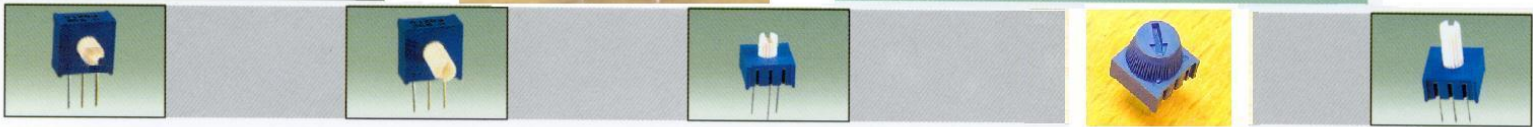

Electrical Characteristics

Standard Resistance Range	100 to 2 megohms (see standard resistance table)
Resistance Tolerance	±10% std. (tighter tolerance available)
Absolute Minimum Resistance	1% or 2 ohms max. (whichever is greater)
Contact Resistance Variation	3% or 3 ohms max. (whichever is greater)
Adjustability	Voltage ±0.05% Resistance ±0.15%
Resolution	Infinite
Insulation Resistance	500 Vdc 1,000 megohms min.
Dielectric Strength	101.3 kPa 500 Vac 8.5 kPa 350 Vac
Adjustment Angle	260° nom.

Environmental Characteristics

Power Rating (250 volts max.)	0.5 watt (70°C), 0 watt (125°C)
Temperature Range	-55°C to +125°C
Temperature Coefficient	±100ppm/°C
Vibration	98 m/s ² (1% Δ TR; 1% Δ VR)
Shock	390 m/s ² (1% Δ TR; 1% Δ VR)
Load Life	1,000 hours 0.5 watt @ 70°C (3% Δ TR; 4% or 4 ohms, Whichever is greater, CRV)
Rotational Life	200 cycles (3% Δ TR; 4% or 4 ohms, Whichever is greater, CRV)

How to order

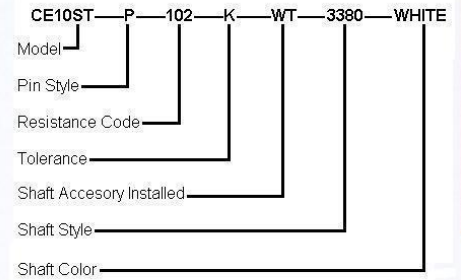

Physical Characteristics

Mechanical Angle	280° nom.
Torque	20 mN • m max.
Stop Strength	50 mN • m min.
Terminals	Solderable pins
Standard Packaging	50 pcs. per tube

Common Dimensions Top Adjustment

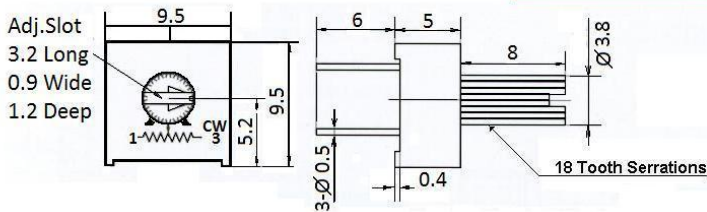

Common Dimensions Side Adjustment

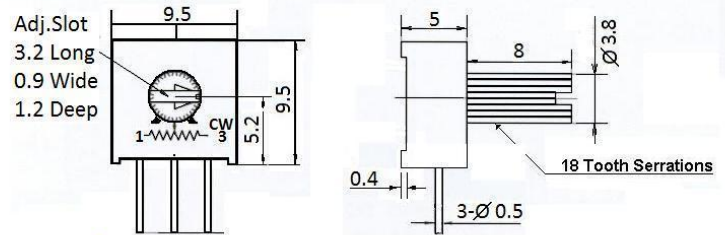

NOTE:
All of the same CE10ST series
Pin Configurations are available
with 3380 or 6656 adjustment
accessories

3880 Shaft

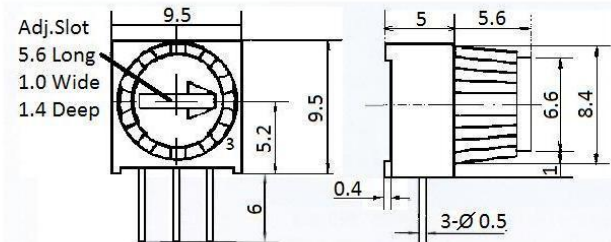
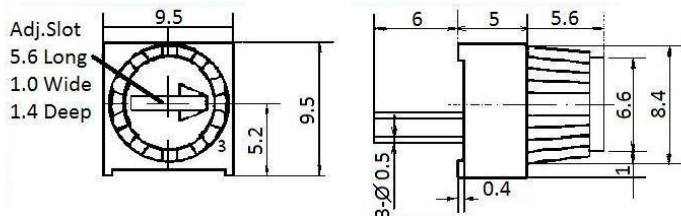

6656 Knob